

Dear partners

We have improved our product range and replaced our previous version of our hydraulic pumps, hand cranks and friction clutch.

What is changed?

We will change to a hexagonal spindle design replacing the Spindle "Type A" flattened and Spindle "Type W" Woodruff spindle designed. By switching to a hexagonal spindle design, we have not only been able to improve the assembly process, but also simplify the product range. Simplifying the range helps to reduce complexity for customers and make it easier to select the right product.

Additionally, the all hand-crank will be replaced by a single hexagonal hand crank design with click-functionality which allows easy attachment.

Finally, the friction clutch will also be changed to a hexagonal design. It will have smaller dimensions and be made of stainless steel.

Pump spindle shaft

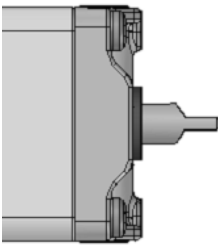
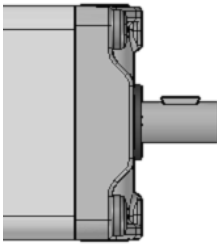
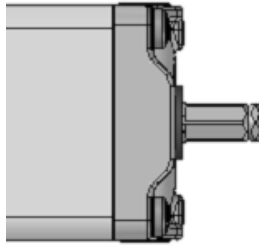
<p>Pump PA / PB / PF</p>  <p>Typ «A» (flattened) 10X.0XXXX</p> <p>Pump with HC 31X.2XXXX</p>	 <p>Typ «W» (Woodruff) 10X.2XXXX</p> <p>Pump with motor 32X.2XXXX</p>	<p>→ werden ersetzt durch →</p>	<p>Pump PA / PB / PF</p>  <p>Typ «H» (Hexagon) 10X.3XXXX</p> <p>Pump with HC Pump with Motor 32X.3XXXX 32X.3XXXX</p>
---	---	---	--





Overview of the old and new number range.

Current numbers			New numbers		
100,102,103	.0XXXXX .2XXXXX	Pump	100,102,103	.3XXXXX	Pump
310,312,313	.2XXXXX	with Hand crank	310,312,313	No longer required as the hand crank is ordered as a separate item.	
320,322,323	.2XXXXX	with Motor unit EU	320,322,323	.3XXXXX	with Motor unit EU
330,332,333	.2XXXXX	with Motor unit CH	330,332,333	.3XXXXX	with Motor unit CH
360,362,363	.2XXXXX	with Motor unit US	360,362,363	.3XXXXX	with Motor unit US
380,382,383	.2XXXXX	mit SC + HC	380,382,383	.3XXXXX	With Safety Clutch (Hand Crank is ordered as a separate item)

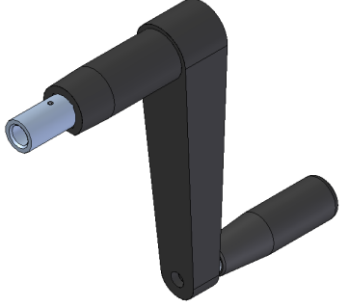
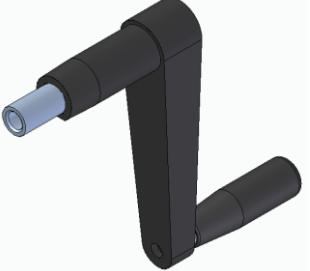

Examples:

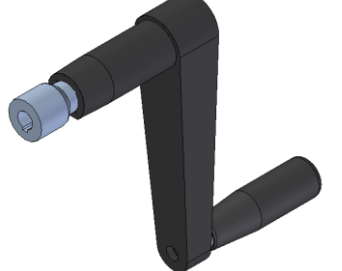
323.20033 Pump PF 4830 with Motor unit (EU) is replaced by 323.30033 Pump PF 4830 with Motor unit (EU).
313.20033 Pump PF 4830 with Hand crank is replaced by 103.20033 Pump PF 4830 and Hand crank H 113.00105.

Hand crank

 <p>Hand crank removable 113.00013</p>	<p><i>*drilled + pinned</i></p>  <p>Hand crank foldable 113.00005 / 90 (RF)</p>	<p style="writing-mode: vertical-rl; transform: rotate(180deg);">will be replaced by ↓</p>	 <p>Hand crank H 113.00105</p> <p><i>*Click-function (drilling + pinning is omitted)</i></p>
 <p>Hand crank Woodruff 113.00065</p>	 <p>Hand crank 90° 113.00070</p>		

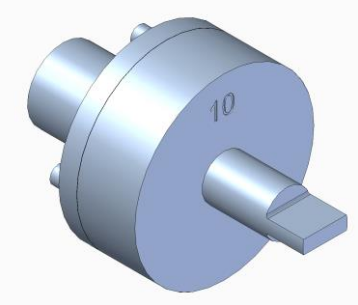
Friction clutch

 <p>Friction clutch 10Nm 113.00022</p> <p><i>*Supplier K&R drilled + pinned Länge 71mm</i></p>	<p style="writing-mode: vertical-rl; transform: rotate(180deg);">wird ersetzt durch ↓</p>	 <p>Friction clutch 10Nm RF (neu) 113.30022</p> <p><i>* In-house production screwed with grub screw Length 62mm</i></p>
--	---	--

The drawings of the hand crank and the friction clutch can be found at the end of the document.

Customer benefits

The change results in:

- **Improved functionality** through ability to remove or fold the crank handle
- **Modularity:** Enables combination with different systems
- **Compatibility:** Seamless integration with previous models
- **Improved environmental considerations:** Replaceable individual parts reduce waste
- **Easier** repair and replacement of friction clutch and hand crank
- **Simplified** ordering and repair process for a better customer experience
- **Unchanged price level** despite improved product functionality
- **Easier local stock management** through keeping fewer variants

Changeover process

From calendar week 48/2024, Ergoswiss will automatically create quotations with the new article numbers and deliver with the new article numbers from January 2025.

Spare parts for the old products will be available until further notice.

Price information

The prices for the Pump with Motor Unit and Hand crank remain unchanged.

If you have any questions, please feel free to contact us. Our technical support team will be pleased to help you.

Kontakt Daten:
Tel. +41 71 727 06 70
info@ergoswiss.com

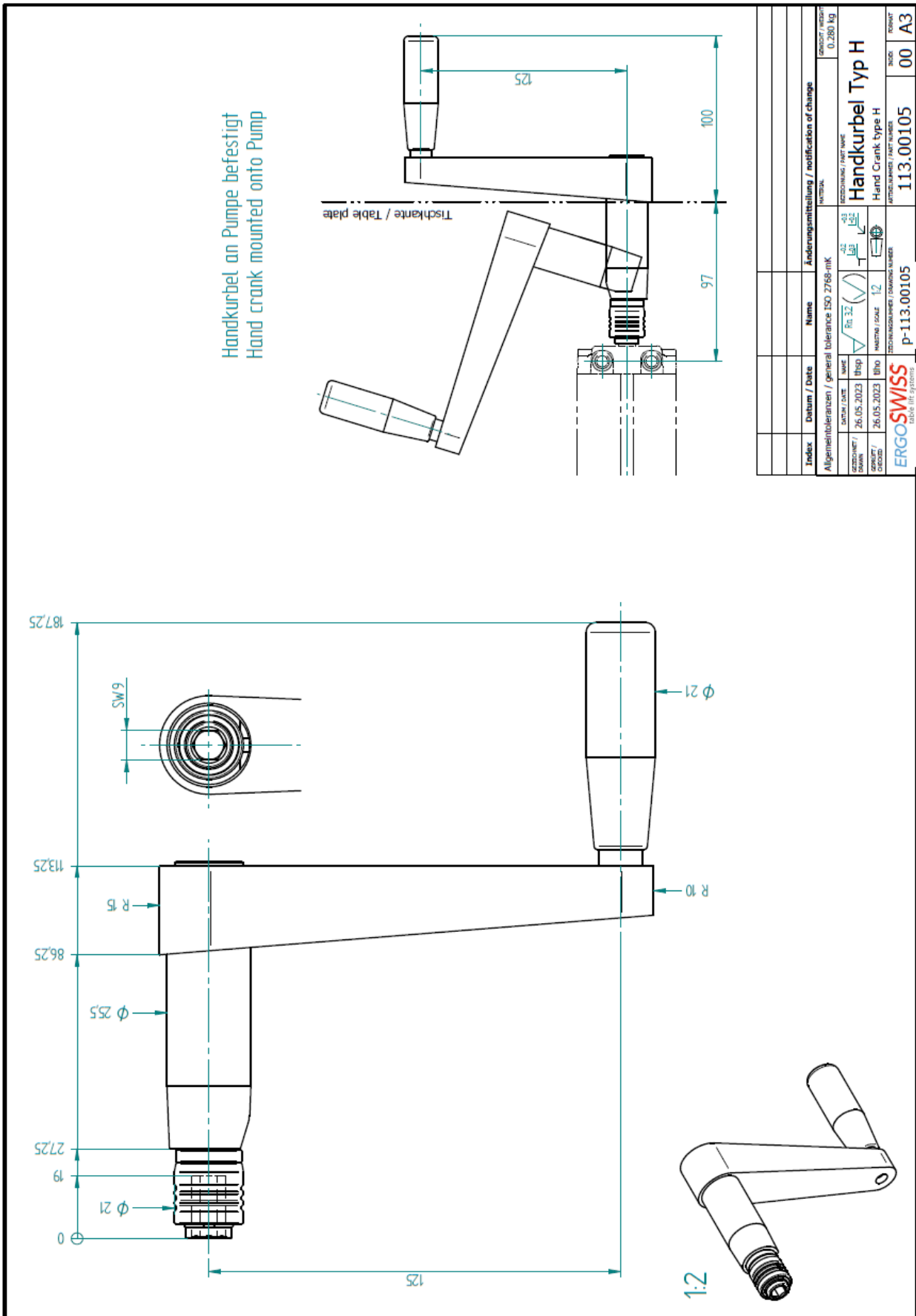

Je nach Federpaket kann es zu einem Längenunterschied von bis zu 2 mm kommen
Depending on the spring package, there may be a length difference of up to 2 mm!

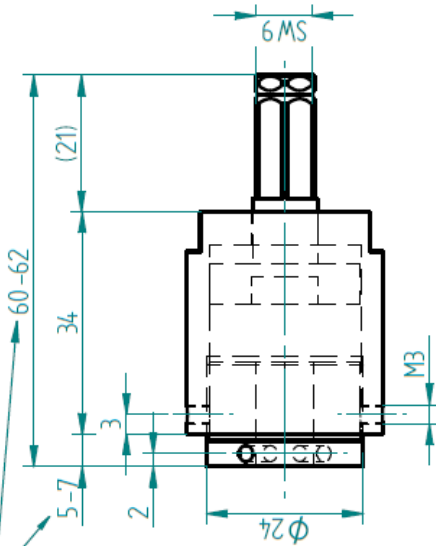
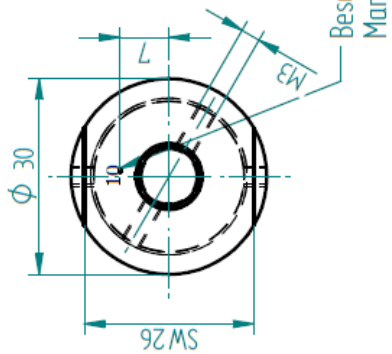

inklusive / inclusive

- 3x 142.00346 Tellerfeder 11,2 / 22,5 / 1,25
- 2x 142.00347 Gewindestift M3x8
- 2x 142.00348 Gewindestift M3x3
- 1x 125.00433 RK Distanzscheibe 30x10,5x3
- 2x 125.00434 RK Reibbelag 30x10,5x3
- 3x 142.00346 Disc Spring 11,2 / 22,5 / 1,25
- 2x 142.00347 Grub screw M3x8
- 2x 142.00348 Grub screw M3x3
- 1x 125.00433 RK spacer 30x10,5x3
- 1x 125.00434 RK friction lining 30x10,5x3

Drehmoment 10 Nm (+/- 1 Nm)

Torque 10 Nm (+/- 1 Nm)

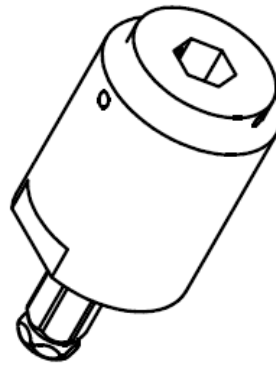

Index	Datum / Date	Name	Änderungsmittteilung / notification of change
NAME	07.02.2024	hafi	BEZEICHNUNG / ASSEMBLY NAME
GEZEICHNET / DRAWN	07.02.2024	hafi	0.168 kg
GEPRÜFT / CHECKED	07.02.2024	mito	1
ERGOSSWISS table lift systems			ARTIKELNUMMER / ASSEMBLY NUMBER 113.30022
			INDEX 00
			FORMAT A4